

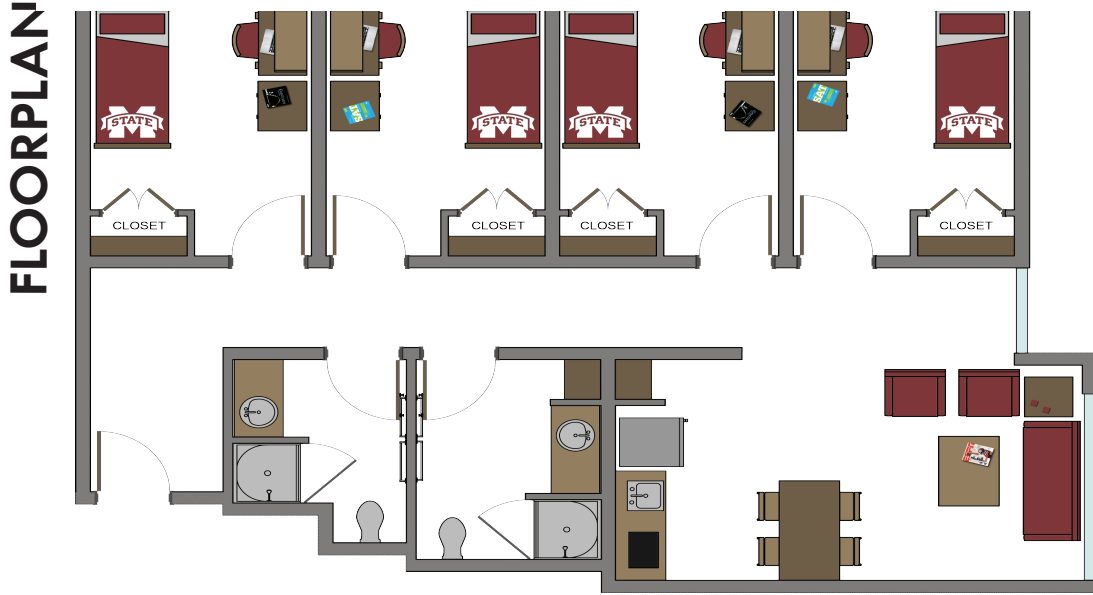

Deavenport & Dogwood | Quad Suite Room Package



FLOORPLAN

DIMENSIONS

Total Unit Size: 29' W x 38'-2" D

BEDROOM

Each Bedroom: 9'-0" W x 12'-10" D
 Window: 5'-8" W x 5'-4" H
 Window to Ceiling: 2'-0" H
 Closet: 4'-0" W x 2'-0" D
 Shelf in Closet: 4'-0" W x 1'-0" D
 Shelf to Ceiling: 3'-2" H
 Hanging Rod in Closet: 4'-0" W
 Hanging Rod to Floor: 5'-10" H

BATHROOM 1

Counter: 3'-10" W x 2'-0" D
 Sink: 1'-7" W x 1'-7" D
 2
 Under Sink Cabinet: 1'-0" W x 2'-0" D x 2'-8" H
 Mirror: 3'-10" W x 3'-4" H
 Shower: 3'-0" W x 2'-9" D
 Toilet Area: 3'-0" W x 3'-0" D
 Towel Rack (2): 2'-0" W

BATHROOM 2

Counter: 4'-5" W x 2'-0" D
 Sink: 1'-7" W x 1'-7" D
 Under Sink Cabinet: 1'-6" W x 2'-0" D x 2'-8" H
 Mirror: 4'-5" W x 3'-4" H
 Shower: 3'-0" W x 2'-9" D
 Toilet Area: 4'-10" W x 3'-0" D
 Towel Rack (2): 2'-0" W
 Shelving: 2'-0" W x 1'-6" D (5 total, spaced 14", starting at 28" AFF)

SHARED KITCHEN SPACE

Kitchenette: 11'-0" W x 5'-2" D
 Countertop: 5'-6" W x 2'-0" D
 Shelving: 2'-0" W x 1'-6" D (5 total, spaced 14", starting at 28" AFF)

SHARED LIVING SPACE

Living Room 11'-0" W x 14'-8" D
 Window: 9'-4" W x 7'-8" H
 Corridor: 4'-0" W x 38'-8" D
 Window: 3'-8" W x 7'-8" H

FURNITURE IN EACH BEDROOM:

Each bed has a metal bed frame inside of the wooden bed frame there are pegs in the wooden bed frame that the metal frame fits in, this is how you adjust the bed's height.

Bunk able Wooden Bed Frame:
85.5 in L x 38 in W x 32 in H

Metal Bed Frame: (part of the wooden)
35.5 in W x 22-32 in H (height can be adjusted)

Pegs to adjust height in Metal Frame
12 pegs total; 3 in of space between

Mattress:
36 in W x 80 in L x 7 in H

Desk:
42 in W x 24 in D x 30 in H

Built in Desk Drawers:
Pullout Drawer above Chair Space:
18 in W x 25 in D x 2.5 in H

Three drawers are on the left side of the desk:
Top Two Drawers:
13 in W x 17 in D x 4.5 in H

Bottom Drawer:
13 in W x 19 in D x 12 in H

Desk Shelves (Each are built in above the desk)
16.5 in H from desk to the first shelf
10 in H from first shelf to second
both shelves are 38 in W x 16 in D

Desk Chairs:
Chair Back:
19 in W x 8 in H
Seat of Chair:
18 in W x 19 in D

Dresser:
30 in W x 24 in D x 30 in H

Dresser Has 3 Drawers:
Small Drawers (Two):
28 in W x 18 in D x 6 in H

Larger Drawer (One):
28 in W x 18 in D x 12.5 in H